

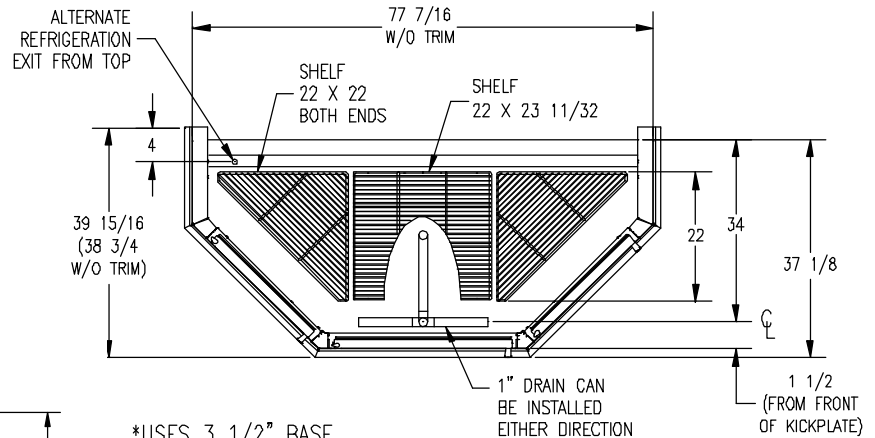

# 3RMCCWAFL SPECIFICATION SHEET

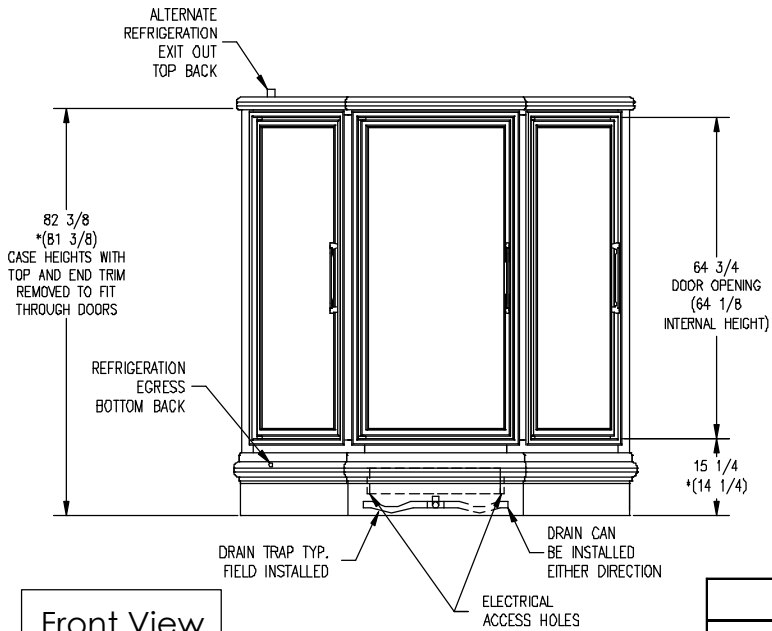

Top View



Front View

REFRIGERANT CONNECTIONS			
MODEL NUMBER	SUCTION LINE O.D.	LIQUID LINE O.D.	SUCTION LINE O.D. FOR REFRIG. OUT TOP BACK
3RMZCWAF	7/8	3/8*	5/8
* IF HOT GAS DEFOST LIQUID LINE IS 1/2			

CAPACITY & WEIGHT SPECIFICATIONS		
MODEL NUMBER	CAPACITIES	
	USABLE CUBIC FEET	VERTICAL SURFACE SQUARE FOOTAGE
3RMZCWAF	39	38 (ESTIMATE)
	WEIGHT IN POUNDS	
	920 (ESTIMATE)	
*WEIGHT BASED ON UNCRATED CASE FULLY SHELVED.		

ELECTRICAL SPECS. BY DOOR MANUFACTURER				
MODEL NUMBER	FANS AMPS	T-8 LIGHTS AMPS	T-10 LIGHT AMPS	ANTI-SWEAT HEATERS
<b>ANTHONY DOORS</b>				
3RMZCWAF	1.02	2.91	3.00	3.24
SUBTRACT 0.57 AMPS FOR PSC FAN MOTORS VOLTAGE: 115 VOLTS 1 PHASE 60 HZ.				

BTU/HR ENERGY REQUIREMENTS: FOR PRODUCT TEMPERATURE OF 33°F TO 41°F WITH 25°F EVAPORATOR		
MODEL NUMBER	BTU/HR @ +25°F	BTU/HR RATING BASED ON T-8 LIGHTING AND PARALLEL RACK SYSTEM.
3RMZCWAF	3,680	ADD 150 BTU/HR FOR T-10 LIGHTING CASE DESIGNED TO OPERATE IN AN AMBIENT OF 75°F OR LOWER AND RELATIVE HUMIDITY OF 55% OR LOWER. DEDUCT 170 BTU/HR FOR PSC FAN MOTORS
	FOR ELM AT +25°F DEDUCT 650 PER HOUR	

Zero Zone, Inc. • 110 N. Oakridge Dr.  
North Prairie, WI 53153-9792  
1-800-247-4496 • FAX: 1-262-392-6450  
www.zero-zone.com



All specifications are subject to change without notice.

3RMCCWAF  
04045